

COMBI 740 is an electro-hydraulic operator consisting of a drive unit - motor/pump - and a hydraulic jack.
 For safety reasons, anti-crush, the unit motor-pump-jack is fitted with pressure valves incorporated in the hydraulic circuit and adequately protected to prevent misuse after the operator has been installed on the gate.
 Designed so that it is unaffected by rain, water, dust or any other atmospheric agent.
 COMBI 740 is to be sunk into the ground at the foot of the gates on the right-hand and left-hand side (double swinging gates) to achieve synchronized operations.
 Different options are available, ie. 110° or 175° rotation angle with no variation in size, with or without dampening device on both open and close cycles. With or without two-way locking device. A locking unit can be released for hand operations by means of the lever placed above the pressure valves. The units are supplied perfectly working and already filled with special oil.
 No pre-adjustment is needed, the operator is ready to work after completing the installation.
 The gate can be fixed onto the COMBI 740 operator in three different ways: by the emergency release bracket (for hydraulic jacks with hydraulic locking device), the support plate with square-bored ferrule (for hydraulic jacks without hydraulic locking device) and the square-bored ferrule (for hydraulic jacks without hydraulic locking device).
 In all the cases, these elements are to be firmly welded to the base of the gate and aligned with the gate upper pivot.
 Tested and certified **CE** marking and type testing according to ITT PDC No. 2393-2008.

TECHNICAL SPECIFICATIONS

TWO-PHASE CLASS H ELECTRIC MOTOR

Power output	0,18 kW (0,25 HP)
Absorbed power	250 W
Frequency	50 Hz
Supply voltage	230 Vac
Absorbed current	1,2 A
Capacitor	12,5 µF
Motor rotation speed	1.350 rpm
Intermittent service	S3

PERFORMANCE (110° shaft rotation angle)

Frequency of use	very intensive
Service cycle	opening ~ 23 s dwell 30 s closing ~ 23 s dwell 30 s
Complete cycle time	~ 106 s
Complete cycles	
opening-dwell-closing-dwell	No. 34/hour
Annual cycles (with 8 hours of use per day)	No. 99.280

DOUBLE STROKE JACK AND OIL-HYDRAULIC PUMP

P3 - Hydraulic pump capacity	0,85 l/min
Working temperature	-20°C +80°C (*)
Oil type	Oil Fadini - Item 708L
Shaft rotation	110° - 175°
Working torque	250 - 400 Nm
Piston diameter	75 mm
Piston stroke	52 mm
Weight with enclosure	27 kg
Protection standard	IP 67
Max. gate weight per leaf	700 kg
Max. gate width per leaf	4 m
Dimensions (length x width x height)	470x300x140 mm

PERFORMANCE (175° shaft rotation angle)

Frequency of use	very intensive
Service cycle	opening ~ 28 s dwell 30 s closing ~ 28 s dwell 30 s
Complete cycle time	~ 116 s
Complete cycles	
opening-dwell-closing-dwell	No. 31/hour
Annual cycles (with 8 hours of use per day)	No. 90.520

NOTE: It is always recommended to install an electric lock with gate leaves wider than 2,0 m.

(*) -40 °C with specific optional accessories (Ref. General Catalogue).

VERSIONS

- Braking in opening and closing
- Non braking
- Hydraulic device for bidirectional locking
- Non locking (reversible): an electric lock is needed
- With flow regulator

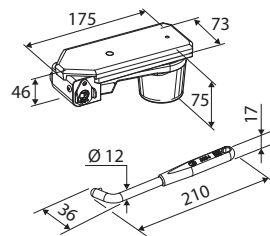
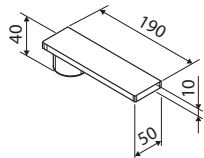
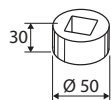
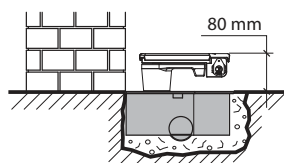
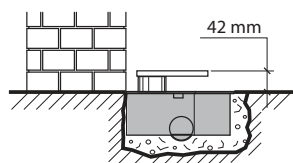
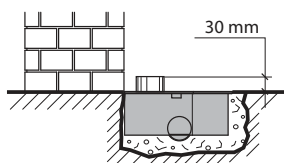

Square-bored ferrule

Squared-bored ferrule with support plate

Emergency release bracket with square-bored ferrule, spanner and plate to weld

